

**9005/6-GX
GX-ASSIST COMPONENTS**

- 31. Attachment Plate
- 32. Pneumatic Spring
- 32A. Ball Stud
- 32B. Chicago Bushing
- 32C. Rod Clevis Pin
- 32D. Ball Socket Clip
- 32E. E-Clip
- 33A. Pivot Screw
- 33B. Pivot Bushing
- 33C. Plastic Shims
- 35A. Lever Pivot Screw
- 35B. Lever Pivot Bushing

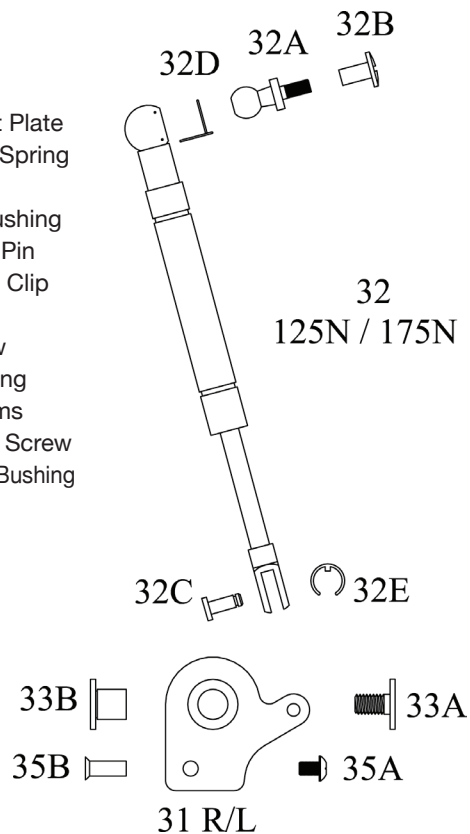

**9005/6-GX
GX-ASSIST COMPONENTS**

- 31. Attachment Plate
- 32. Pneumatic Spring
- 32A. Ball Stud
- 32B. Chicago Bushing
- 32C. Rod Clevis Pin
- 32D. Ball Socket Clip
- 32E. E-Clip
- 33A. Pivot Screw
- 33B. Pivot Bushing
- 33C. Plastic Shims
- 35A. Lever Pivot Screw
- 35B. Lever Pivot Bushing

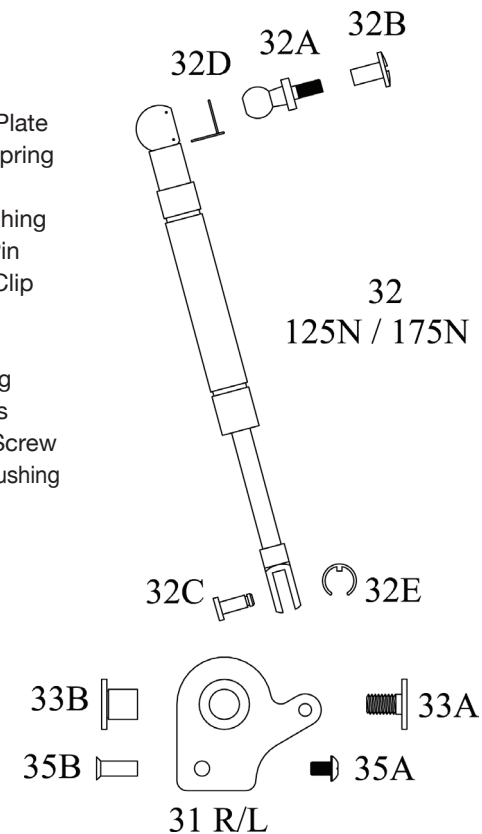

EC REP
Acorn Regulatory Consultancy
Services Limited
Knockmorris Cahir Co. Tipperary Ireland,
Postcode: E21 R766
P 012 4626 8456
F 012 4626 8648



EC REP
Acorn Regulatory Consultancy
Services Limited
Knockmorris Cahir Co. Tipperary Ireland,
Postcode: E21 R766
P 012 4626 8456
F 012 4626 8648



9005/6-GX GX-ASSIST INSTRUCTIONS

1 Fabricate brace per SafetyStride/
FullStride Fabrication Instructions.

2 Connect pneumatic spring to the
attachment plate by inserting the
pin and e-clip. (Figure 1).

3 If more rotation of the spring is
needed, the attachment plate arm
may be angled slightly (Figure 2).

4 Drill a 13/64" hole proximal to
joint center, 5.75" from spring
attachment center (bars must be
contoured before location of hole
is measured) (Figure 3).

**CAUTION: Proximal spring
attachment must be in-line with
joint center. Improper mounting
may damage pneumatic spring.
Verify spring does not limit knee
joint ROM prior to use.**

5 Release clip and remove ball stud
from the socket (Figure 4).

6 Attach the ball stud and chicago
bushing to the orthosis.
(Figure 5).

7 Insert the ball stud back into the
ball socket and secure the ball
socket clip.



Figure 1



Figure 2

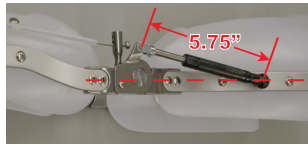

Figure 3



Figure 4



Figure 5



**CAUTION: Do not puncture.
Pneumatic spring under pressure.**

9005/6-GX GX-ASSIST INSTRUCTIONS

1 Fabricate brace per SafetyStride/
FullStride Fabrication Instructions.

2 Connect pneumatic spring to the
attachment plate by inserting the
pin and e-clip. (Figure 1).

3 If more rotation of the spring is
needed, the attachment plate arm
may be angled slightly (Figure 2).

4 Drill a 13/64" hole proximal to
joint center, 5.75" from spring
attachment center (bars must be
contoured before location of hole
is measured) (Figure 3).

**CAUTION: Proximal spring
attachment must be in-line with
joint center. Improper mounting
may damage pneumatic spring.
Verify spring does not limit knee
joint ROM prior to use.**

5 Release clip and remove ball stud
from the socket (Figure 4).

6 Attach the ball stud and chicago
bushing to the orthosis.
(Figure 5).

7 Insert the ball stud back into the
ball socket and secure the ball
socket clip.



Figure 1



Figure 2

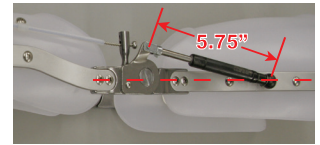

Figure 3

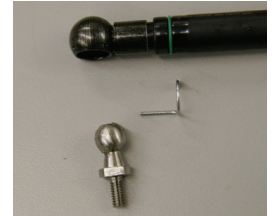

Figure 4

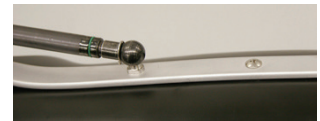

Figure 5



**CAUTION: Do not puncture.
Pneumatic spring under pressure.**